



NEW

INDUSTRIAL LAMPS



07/2021



NEW

INDUSTRIAL LAMPS



COD.58418200
Mod. 10 Color Grey

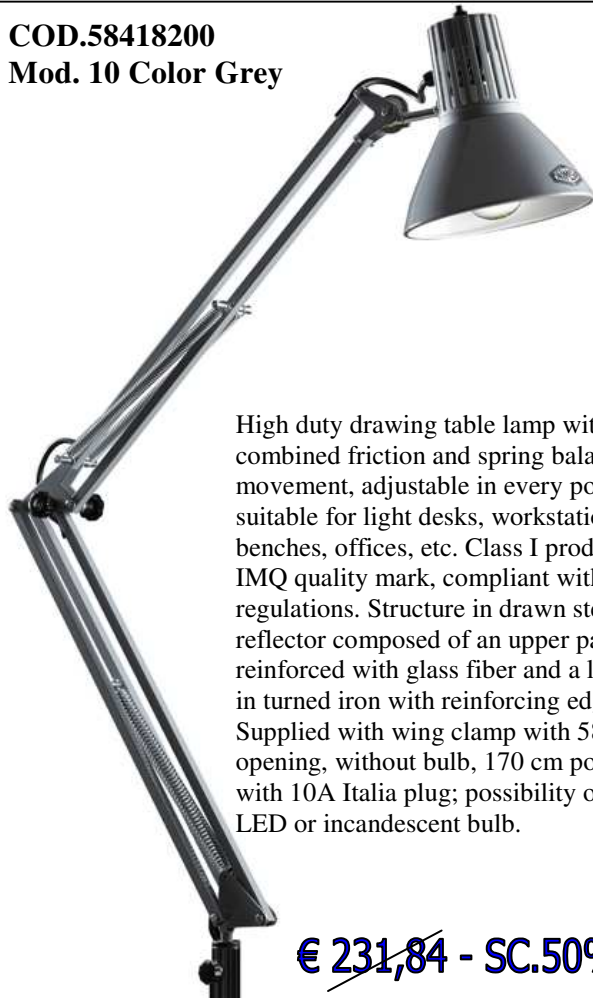

High duty drawing table lamp with combined friction and spring balance movement, adjustable in every position, suitable for light desks, workstations, test benches, offices, etc. Class I product with IMQ quality mark, compliant with CE regulations. Structure in drawn steel, reflector composed of an upper part in nylon reinforced with glass fiber and a lower part in turned iron with reinforcing edge. Supplied with wing clamp with 58 mm opening, without bulb, 170 cm power cable with 10A Italia plug; possibility of use with LED or incandescent bulb.

€ 231,84 - SC.50%



COD.58418300
Mod. 10 Color Black

ART. 58418			
DESCRIZIONE DESCRIPTION	UNITA' UNIT	cod. 200	cod. 300
modello model		10	10
colore colour		grigio grey	nero black
potenza power	W	60	
tensione voltage	V	220-240	
attacco lampadina bulb thread		E27	
diametro del riflettore reflector diameter	mm	160	
grado IP IP grade		IP20	
classe class		I	
cavo di alimentazione power cord	cm	H03 VVF 3x0.75 170	
spina plug		Italia 10A 2P+T	

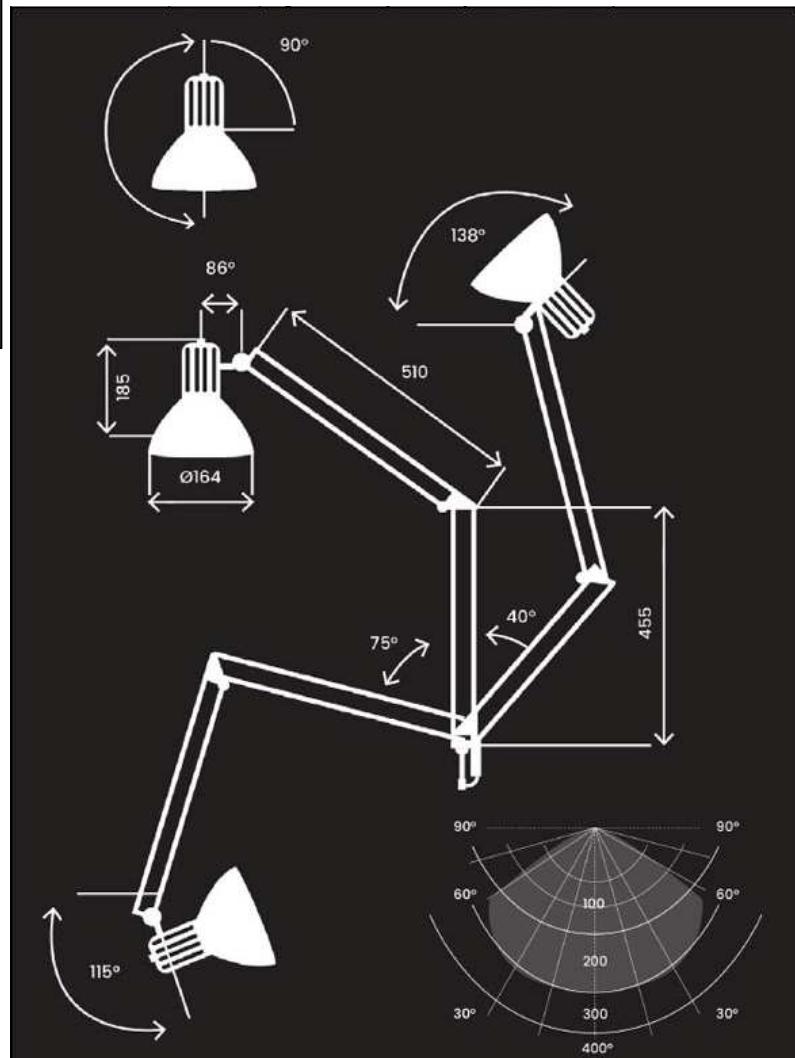

COD.58419188
Mod. 188 LED Color Grey



Balanced LED table lamp 188LED with pantograph arm and magnifying glass series Ciclope, suitable for precision work in the industrial field such as quality control, control of printed circuits, or for the construction of molds; in the graphic field for the control of prints and lithographs; in the private sector for model making, sewing, philately, reading; in the medical field for minor surgery, ophthalmology, podiatry, dermatology; in the aesthetic field for spas or beauty centers. The Ciclope series magnifying glass in polished optical glass, has 3 diopters and offers a magnification increased by 175% compared to the original. Class I product, compliant with CE regulations, supplied with wing clamp with useful opening of 58 mm, with LED bulb, power cord of 175 cm with Italian 10A plug.

€ 478,80 - SC.50%

ART. 58419188

DESCRIZIONE DESCRIPTION	UNITA' UNIT	VALORE VALUE
modello model		188LED
colore colour		grigio grey
potenza power	W	9,5
tensione voltage	V	220-240
illuminamento a cm 50 illuminance at cm 50	Lux	1700
brillantezza brilliance	lm	1280
diottrie diopters		3 175%
temperatura di colore colour temperature	K	6500
diametro del riflettore reflector diameter	mm	230
lunghezza vita life	h	50000
grado IP IP grade		IP20
grado IK IK grade		IK03
classe class		I
cavo di alimentazione power cord	cm	H03 VVF 3x0.75 175
spina plug		Italia 10A 2P+T

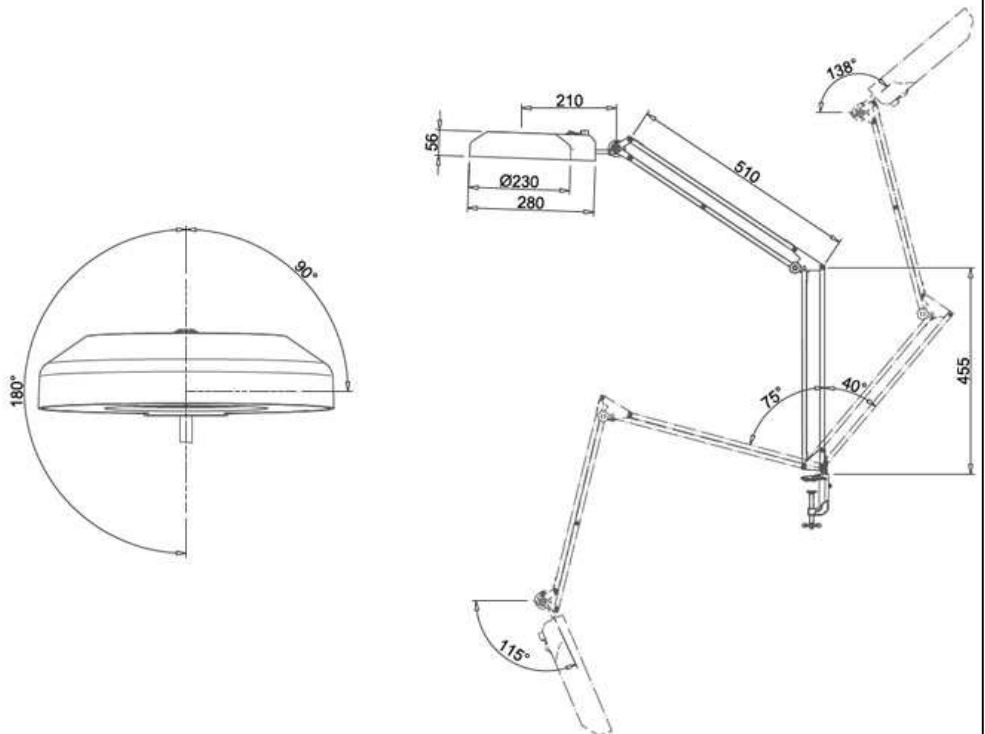



COD.58420200
Mod. MEC 103 Color Black

€ 265,44 - SC.50%

Lamp Mec103 with compensated articulated arm with manual locking via mechanical clutch, specially designed to illuminate work benches and workplaces subject to strong vibrations or where the product is required to maintain a fixed position: ideal for machine tools such as parallel lathes, presses, drills column machines, cutters, sharpeners, transfers, wheels, work benches, industrial staplers and assembly benches. Class I product with IMQ quality mark, compliant with CE regulations. Reflector consisting of a shell in fiberglass-reinforced ABS and a lower part in turned sheet metal with a reinforcing edge. Supplied with a 3-screw ball fixing base that allows installation on both vertical and horizontal surfaces, without bulb; for a more comfortable movement on the reflector there is a handle; 170 cm power cable with Italian 10A plug; possibility of use with LED or incandescent bulb.

COD.58420320
Mod. MEC 103 Color Grey

€ 224,00 - SC.50%

ART. 58420			
DESCRIZIONE DESCRIPTION	UNITA' UNIT	co. 200	cod. 320
modello model		Mec103	
colore colour		nero black	grigio grey
potenza power	W	60	
tensione voltage	V	220-240	
attacco lampadina bulb thread		E27	
diametro del riflettore reflector diameter	mm	160	
grado IP IP grade		IP20	
grado IK IK grade		IK04	
classe class		I	
cavo di alimentazione power cord	cm	H03 VVF 3x0.75 170	
spina plug		Italia 10A 2P+T	

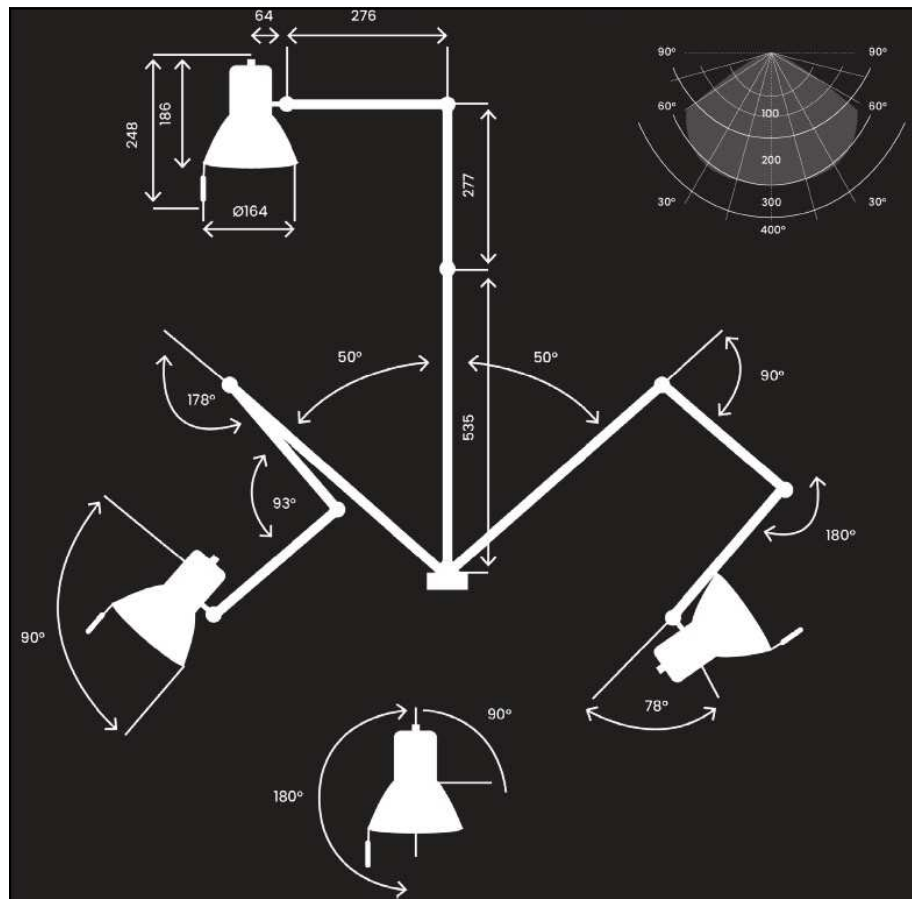



COD.58422420

Mod. L88 LED Color Grey

€ 710,64 - SC.50%

Thanks to the articulated arm it allows to keep the position of use fixed, in the presence of strong stresses or vibrations. S11 Clamp included.

Main features:

- dimmer
- polished optical glass
- plexiglass accurately placed inside the reflector to protect the leds
- pyrex glass
- pantograph with springs
- metal structure
- anti-corrosion paint
- resistant cable.

ART. 58422420

DESCRIZIONE DESCRIPTION	UNITA' UNIT	VALORE VALUE
modello model		L88LED
colore colour		grigio grey
potenza power	W	9,5
tensione voltage	V	220-240
illuminamento a cm 50 illuminance at cm 50	Lux	1700
brillantezza brilliance	lm	1280
diottrie diopters		3 175%
temperatura di colore colour temperature	K	6500
diametro del riflettore reflector diameter	mm	230
lunghezza vita life	h	50000
grado IP IP grade		IP20
grado IK IK grade		IK03
classe class		I
cavo di alimentazione power cord	cm	H03 VVF 3x0.75 175
spina plug		Italia 10A 2P+T

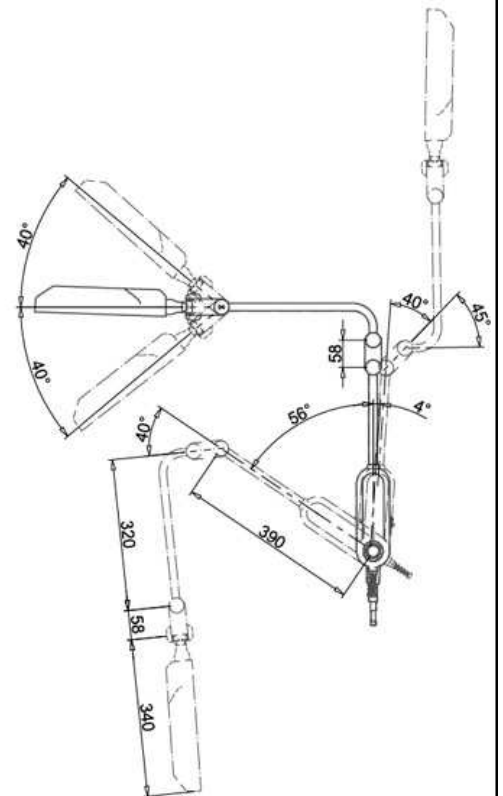
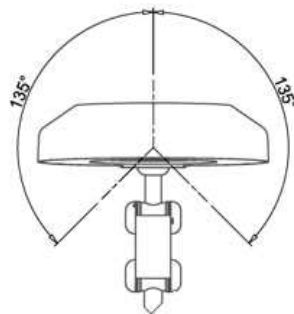
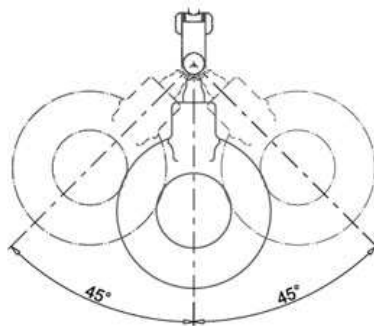

COD.58427350
Mod. 050 LED Color Grey

€ 588,00 - SC.50%



The model is suitable for use on machine tools – the arm structure and its flexibility allow maximum freedom of movement.

- Features:
- Metal structure
 - Flexible arm
 - Printed circuit boards
 - Anti-corrosion paint
 - Pyrex glass

COD.58427880
Magnetic Base Mod. C80



€ 126,00 - SC.50%

ART. 58427350		
DESCRIZIONE DESCRIPTION	UNITA' UNIT	VALORE VALUE
modello model		050LED
colore colour		nero black
potenza power	W	7
tensione voltage	V	220-240
illuminamento a cm 50 illuminance at cm 50	Lux	6600
brillantezza brilliance	lm	270
temperatura di colore colour temperature	K	5500
diametro del riflettore reflector diameter	mm	90
lunghezza vita life	h	50000
grado IP riflettore reflector IP grade		IP66
grado IP vano componenti component compartment IP grade		IP40
grado IK IK grade		IK05
classe class		I
cavo di alimentazione power cord	m	H05 RN-F 3G1 2
spina plug		Italia 10A 2P+T

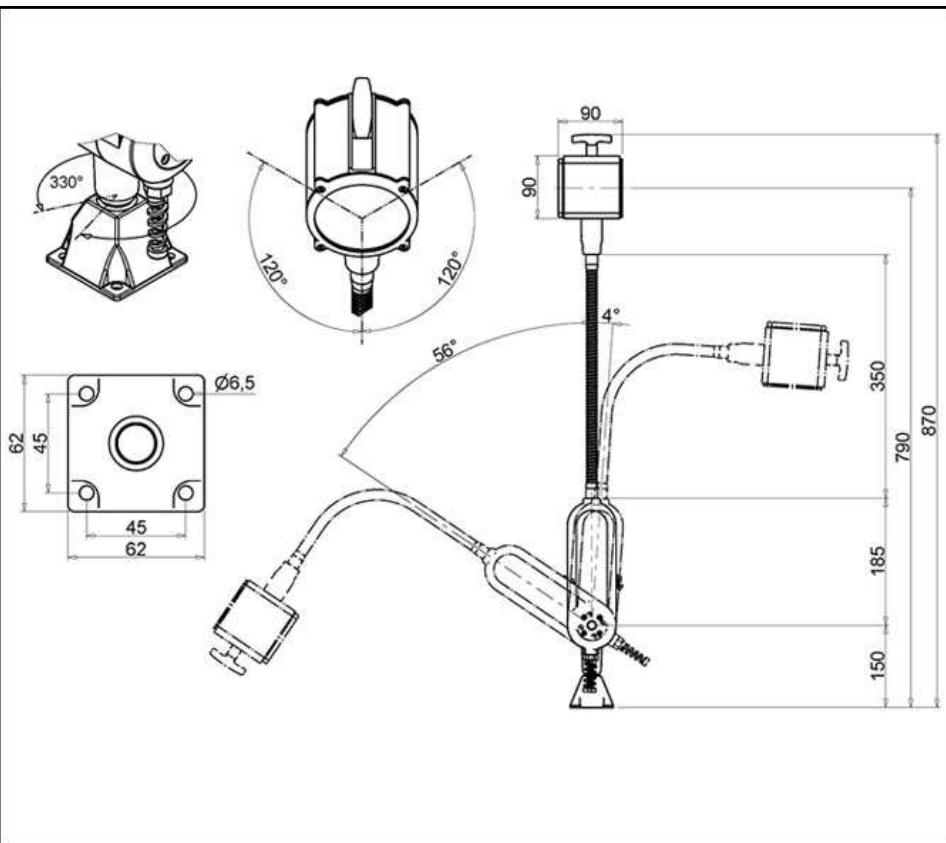



COD.58430100
Mod. MC1 Color Black

€ 588,00 - SC.50%

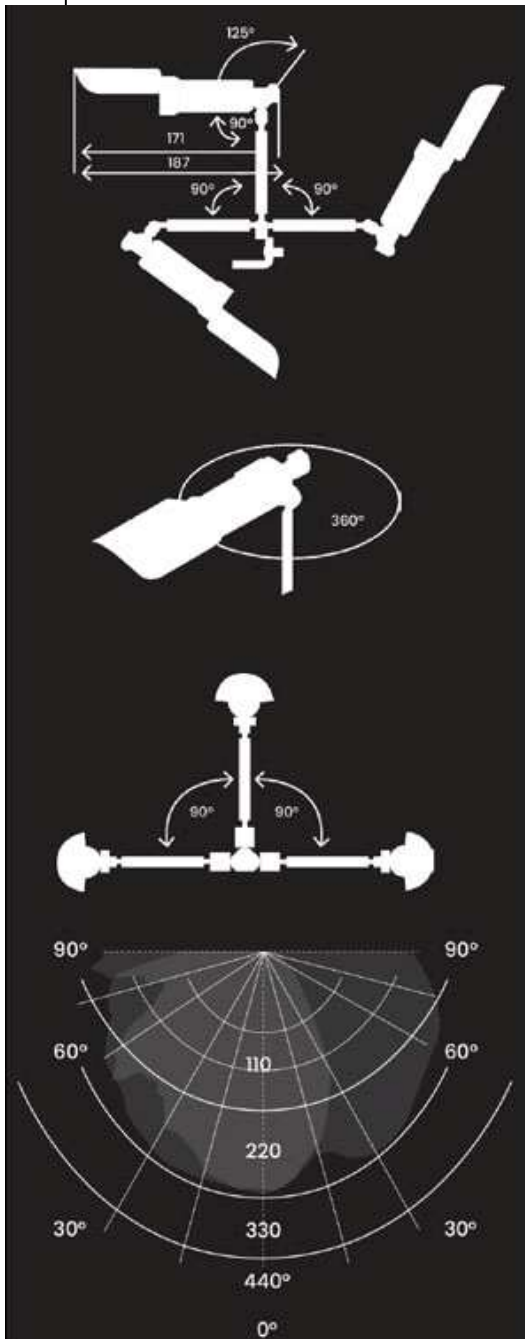

Lamp MC/1CAL 24V with magnet fixing for applications that require the presence of a small light point: pillar drills, operating machines, sewing machines, lighting of paintings and works of art. Molded body in self-extinguishing nylon loaded with glass fiber; the light is controlled by a rocker switch located on the top of the device.

ART. 58430100		
DESCRIZIONE DESCRIPTION	UNITA' UNIT	VALORE VALUE
modello model		MC/1CAL
colore colour		nero black
potenza power	W	25
tensione voltage	V	24
attacco lampadina bulb thread		E14
diametro del riflettore reflector diameter	mm	30
grado IP IP grade		IP20
classe class		III
cavo di alimentazione power cord	cm	2x0.75 100

***PREZZI DA SCONTARE. IVA ESCLUSA.
 PER ARTICOLI DISPONIBILI A MAGAZZINO.
 FINO AD ESAURIMENTO SCORTE.
 OFFERTA LUGLIO 2021.

Gnutti Bortolo Srl - DISTRIBUZIONE INDUSTRIALE

*1937 = 2017: **80 ANNI**, UNA LUNGA STORIA, UNA VERA PASSIONE a fianco delle industrie*

*1937 = 2017: **80 YEARS**, A LONG STORY, A TRUE PASSION next to industries*



Gnutti Bortolo

*DISTRIBUZIONE INDUSTRIALE
INDUSTRIAL DISTRIBUTION*

Via Monsuello 34 — 25065 Lumezzane (Brescia)

ITALY — P. IVA 00547380980

Tel.0308926011 — Fax. 0308926211

info@gnuttibortolo.com

www.gnuttibortolo.com



Gnutti Bortolo Lumezzane